

- NOTES**
1. AIRPORT ELEVATION 2231.38 MEAN SEA LEVEL DATUM
  2. ELEVATION CONTOURS ILLUSTRATE THE HEIGHT LIMITATION WITHIN EACH ZONING SURFACE. CONTOURS ARE ON MEAN SEA LEVEL ELEVATION DATUM.
  3. A SLOPE, SUCH AS 40:1, EXPRESSES THE HORIZONTAL DISTANCE OF 40 FEET TO THE VERTICAL DISTANCE OF 1 FOOT.
  4. RUNWAY APPROACH SURFACE SLOPE IS 40:1.
  5. TOPOGRAPHIC CONTOUR INTERVALS ARE 5 FEET.
  6. EXISTING TOPOGRAPHIC SYMBOLS ARE THOSE USED BY THE U.S. GEOLOGICAL SURVEY.
  7. THIS AIRSPACE ZONING PLAN IS THE PLAN REFERRED TO IN THE AIRPORT ZONING ORDINANCE. COMMUNICATION WITH THE AIRSPACE AND IS TO BE USED ONLY IN CONNECTION WITH SAID ORDINANCE.

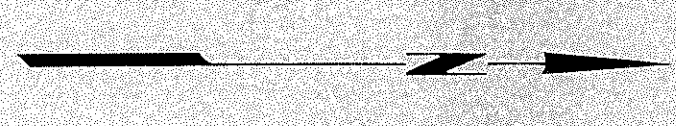
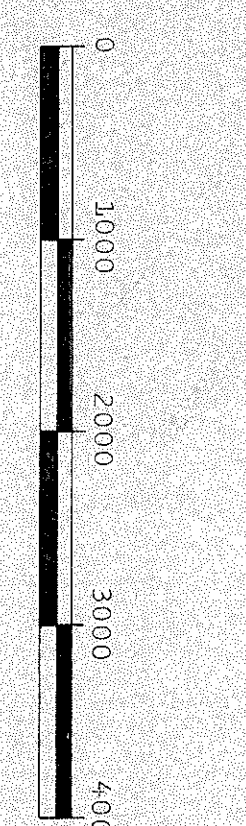
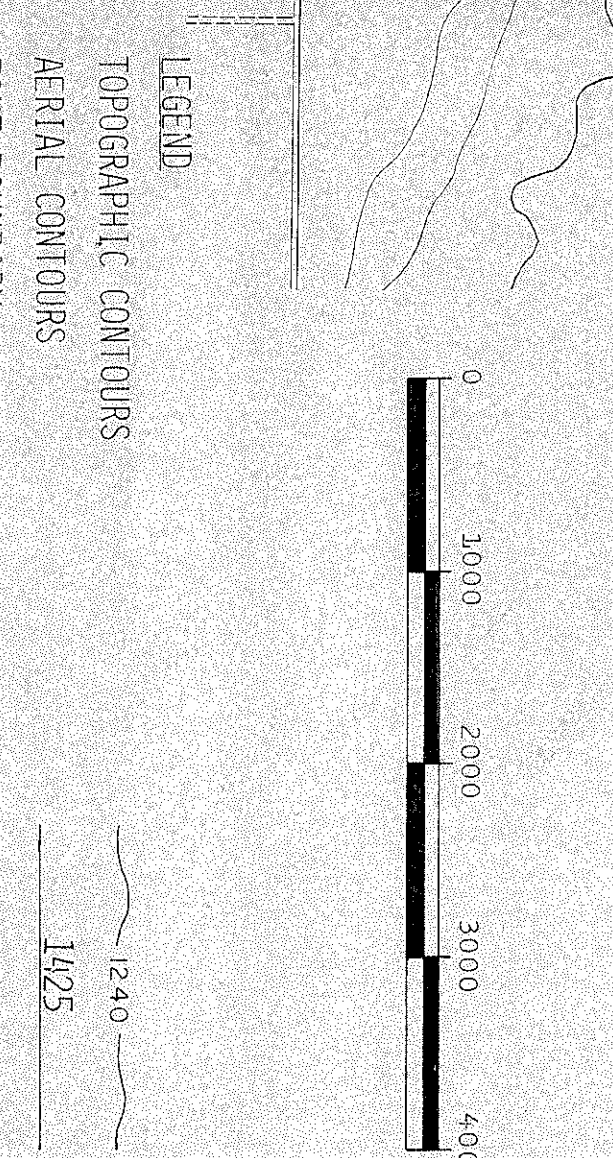

JOB NO. 024.601  
 DATE JULY 2, 1979  
 SHEET NO.

**AIRPORT ZONING PLAN**  
 BIG FALLS MUNICIPAL AIRPORT  
 BIG FALLS, MINNESOTA  
**AIRSPACE ZONING PLAN**

ADOPTED BY THE CITY OF BIG FALLS AIRPORT ZONING BOARD THIS \_\_\_\_\_ DAY OF \_\_\_\_\_ 1979.

**engineers architects land surveyors**  
**STEWART & WALKER INCORPORATED**  
 BEMIDJI THIEF RIVER FALLS

I HEREBY CERTIFY THAT THIS SURVEY, PLAN SPECIFICATION OR REPORT WAS PREPARED BY ME OR UNDER MY DIRECT SUPERVISION AND THAT I AM A DULY REGISTERED PROFESSIONAL ENGINEER UNDER THE LAWS OF THE STATE OF MINNESOTA.  
 JAMES J. WALKER REG. NO. 4473  
 Design\_DDB Drawn\_DDB Checked\_JJK

**Revisions**

1	
2	
3	
4	
5	



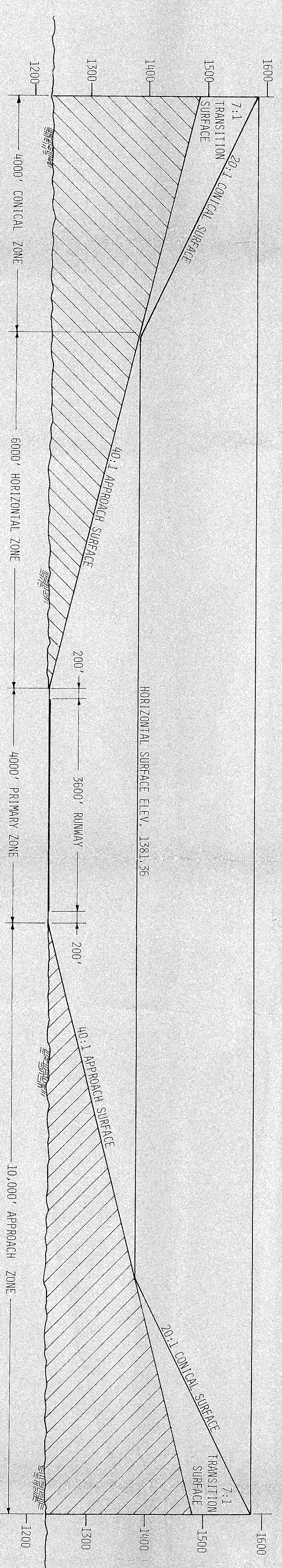
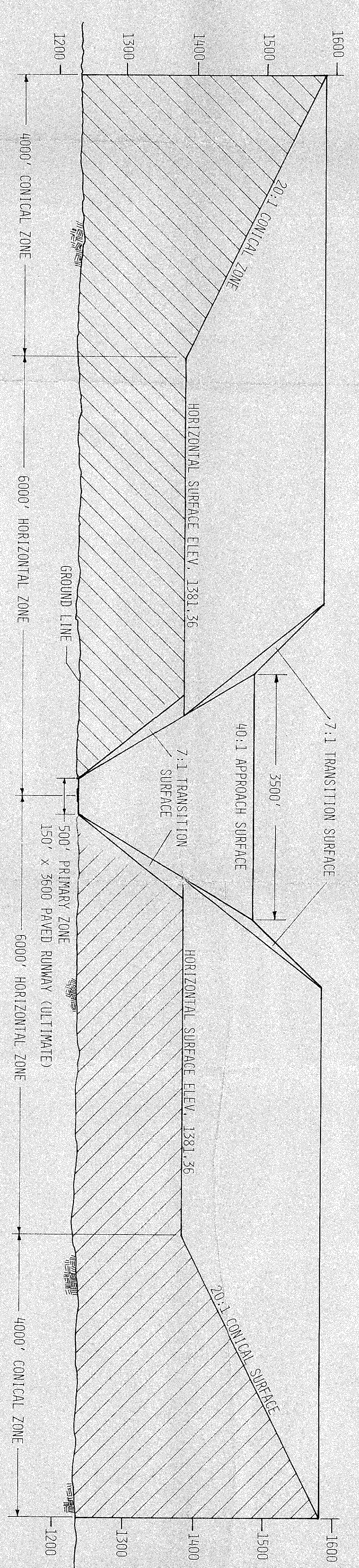
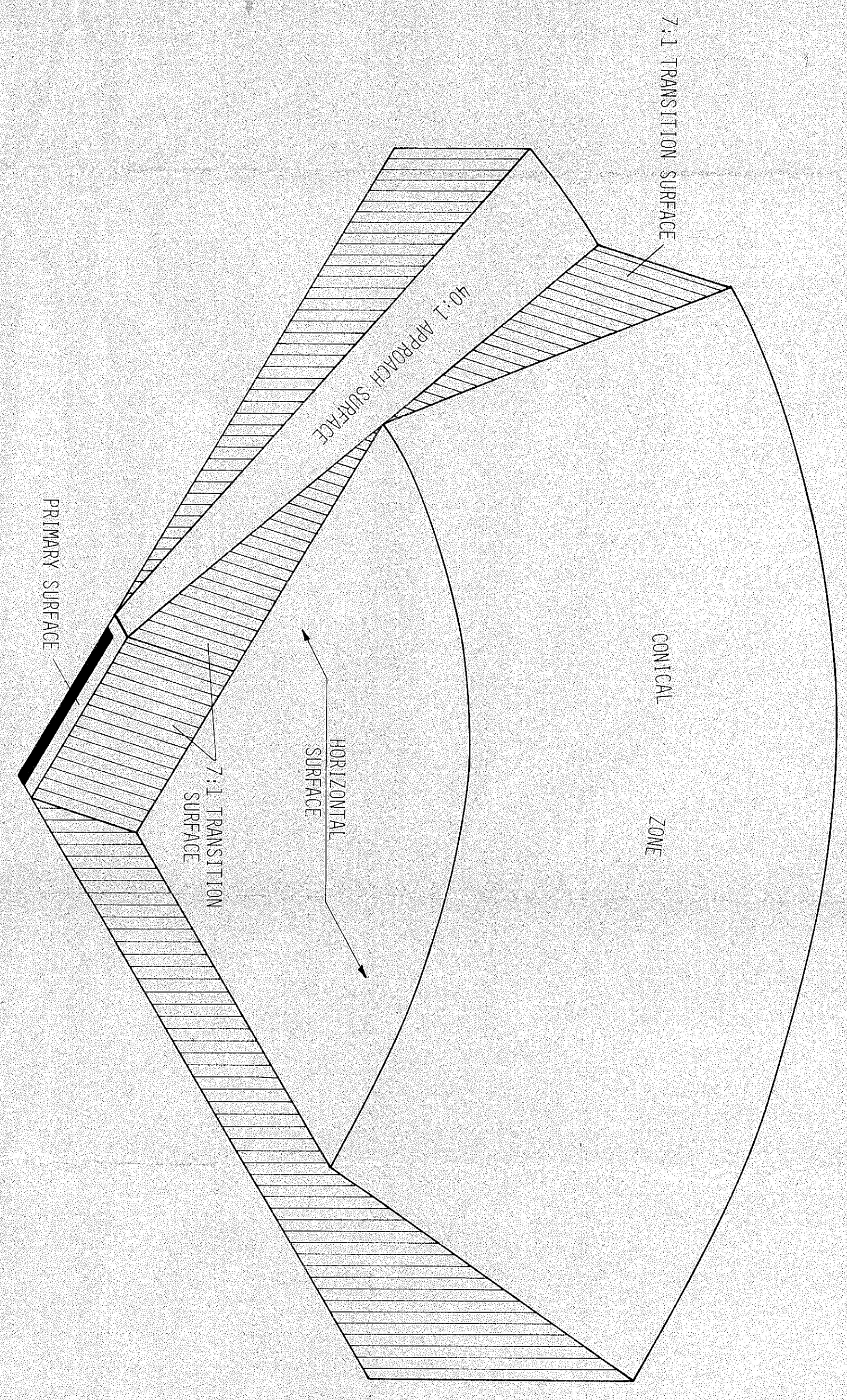

NOTE  
1. THIS AIRSPACE SECTION PLAN IS THE PLAN REFERRED TO IN THE AIRSPACE SECTION PLAN AND IS TO BE USED ONLY IN CONNECTION WITH SAID AIRSPACE SECTION PLAN.

Job No. 56-324  
Date: 10/1/57  
Sheet No.

**AIRPORT ZONING PLAN**  
BIG FALLS MUNICIPAL AIRPORT  
BIG FALLS, MINNESOTA

**AIRSPACE SECTION PLAN**

ADOPTED BY THE CITY OF BIG FALLS AIRPORT ZONING BOARD THIS \_\_\_\_\_ DAY OF \_\_\_\_\_, 1979.

**engineers architects**  
**land surveyors**

STEWART & WALKER INCORPORATED  
BEMIDJI THIEF RIVER FALLS

I HEREBY CERTIFY THAT THIS SURVEY, PLAN SPECIFICATION OR REPORT WAS PREPARED BY ME OR UNDER MY DIRECT SUPERVISION AND THAT I AM A DULY REGISTERED PROFESSIONAL ENGINEER UNDER THE LAWS OF THE STATE OF MINNESOTA.

*James J. Walker*  
JAMES J. WALKER REG. NO. 4473  
Design: DDB Drawn: DDB Checked: JJW

Revisions	
1	
2	
3	
4	
5	



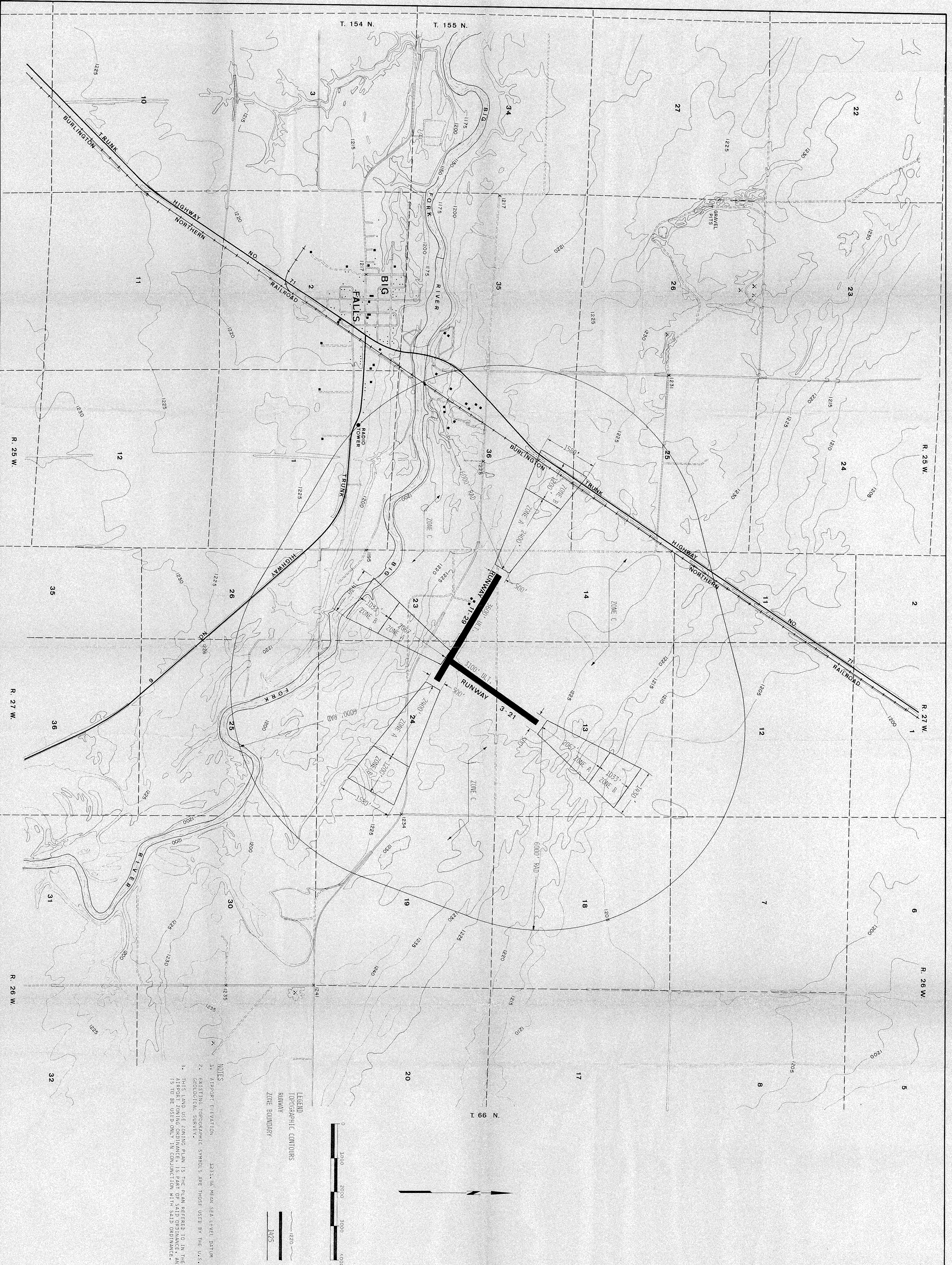

**NOTES**

1. AIRPORT ELEVATION 1233.56 MEAN SEA LEVEL DATUM
2. EXISTING TOPOGRAPHIC SYMBOLS ARE THOSE USED BY THE U.S. GEOLOGICAL SURVEY.
3. THIS LAND USE ZONING PLAN IS THE PLAN REFERRED TO IN THE CITY OF BIG FALLS ZONING ORDINANCE AND SHALL BE USED ONLY IN CONNECTION WITH SAID ORDINANCE.

**LEGEND**

- TOPOGRAPHIC CONTOURS
- RUNWAY
- TAXIWAY
- ZONE BOUNDARY

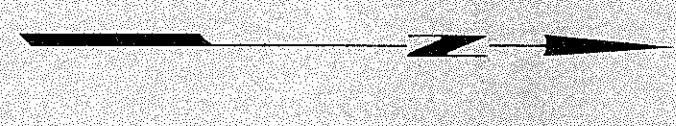
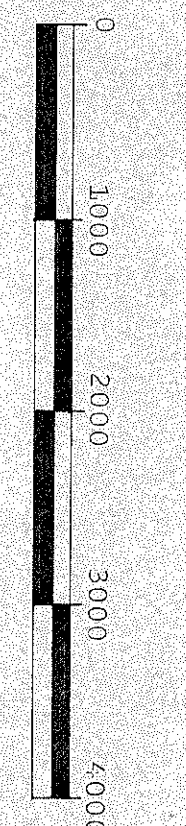

Job No. 06-0013  
Date July 21, 1979  
Sheet No. 3 of 3

**AIRPORT ZONING PLAN**  
BIG FALLS MUNICIPAL AIRPORT  
BIG FALLS, MINNESOTA  
**LAND USE ZONING PLAN**

ADOPTED BY THE CITY OF BIG FALLS AIRPORT ZONING BOARD THIS \_\_\_\_\_ DAY OF \_\_\_\_\_, 1979.

**Stewart & Walker Incorporated**  
engineers architects land surveyors  
BEMIDJI THIEF RIVER FALLS

I HEREBY CERTIFY THAT THIS SURVEY, PLAN SPECIFICATION OR REPORT WAS PREPARED BY ME OR UNDER MY DIRECT SUPERVISION AND THAT I AM A DULY REGISTERED PROFESSIONAL ENGINEER UNDER THE LAWS OF THE STATE OF MINNESOTA.

*James J. Walker*  
JAMES J. WALKER REG. NO. 4478

Design: DDB Drawn: DDD Checked: JJW

Revisions	
1	
2	
3	
4	
5	